

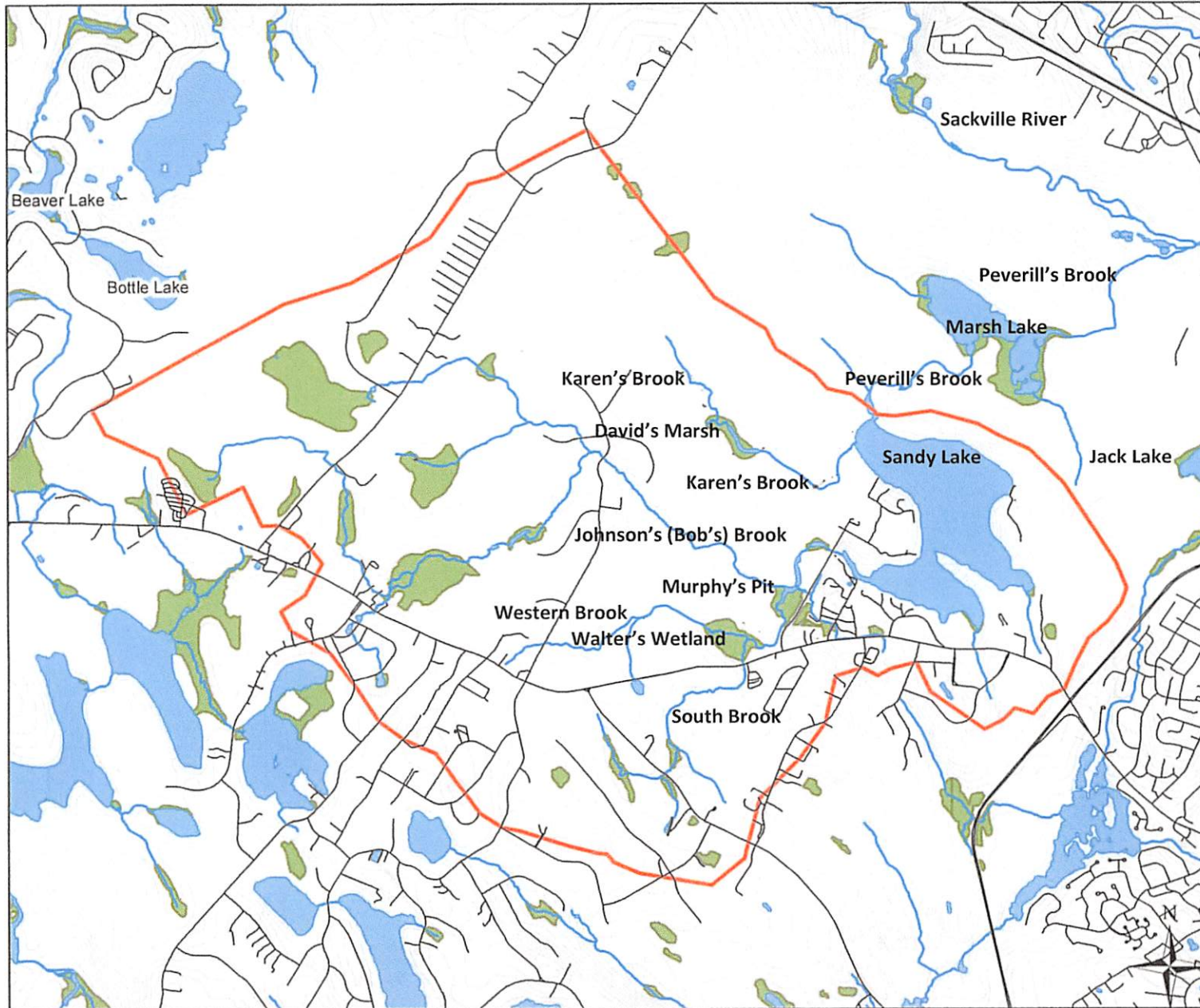

Sandy Lake Catchment Area



Sandy Lake has a surface area of 0.78 square kilometers, and a catchment area of approximately 17.93 square kilometers. Please note this area approximation is based on natural topography and does not account for runoff redirection from roadways or stormwater collection.

Legend

-  Roads
-  SandyLakeWatershed
-  Lakes
-  Rivers
-  MarshLand
-  ContourLines

October 2013

